

Hole plug

Eccentric

Eccentric pin

Wood dowel

155° hinge

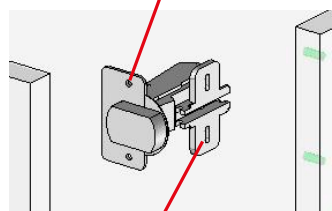

Guide

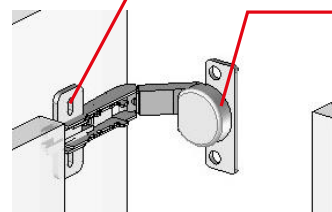

Folding door hinge

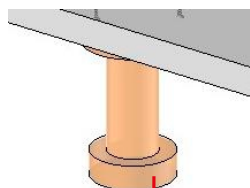

Kitchen furniture leg

1. Left side panel
2. Right side panel
3. Cabinet bottom panel
4. Left back wall
5. Right back wall
6. Left strip
7. Right strip
8. Top left strip
9. Bottom left strip
10. Top right strip
11. Bottom right strip
12. Front left strip
13. Front right strip
14. Door (left/right) 1
15. Door (left/right) 2

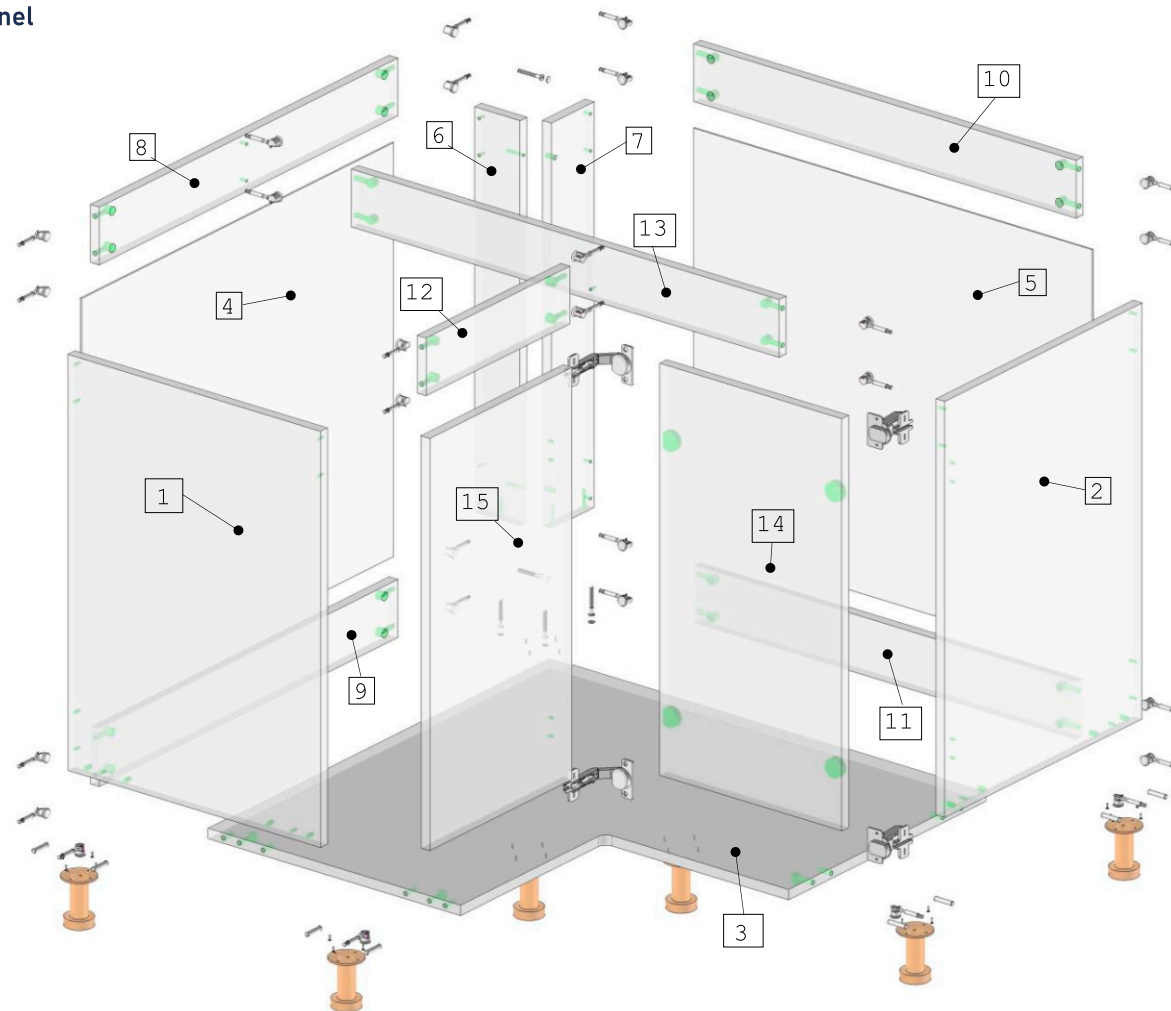



Sink location – cabinet structure

Version - right - sided sink

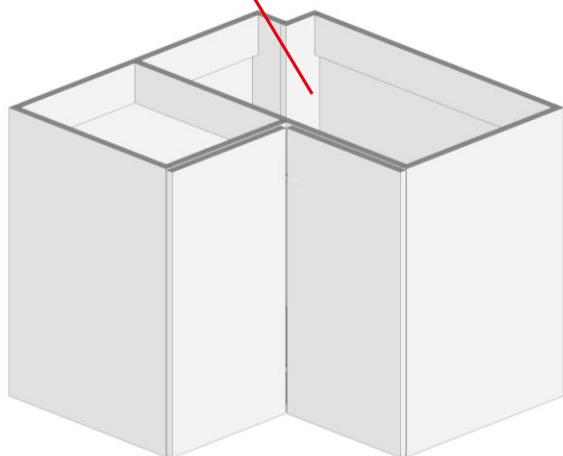

Version - left - sided sink

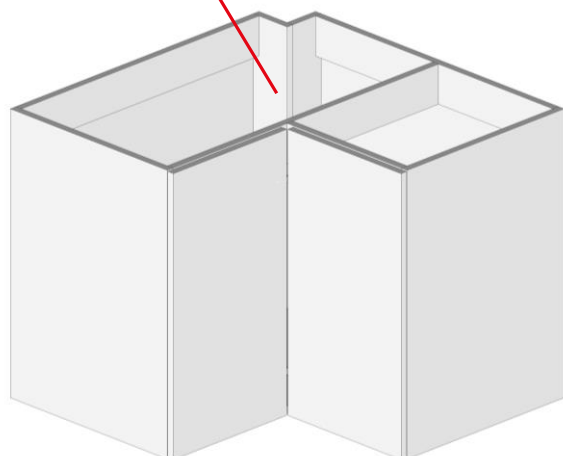

Door opening direction – door layout

(1- front with hinges, 2- front with a hinge guide)

Right door

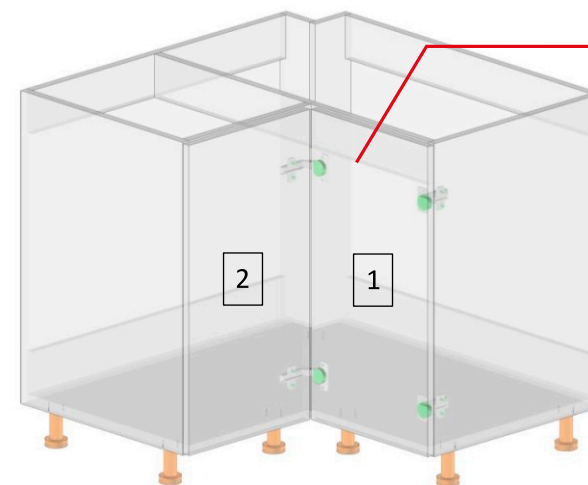

Left door

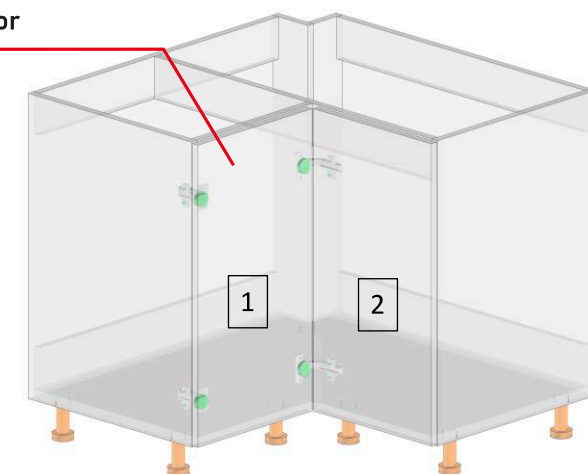



Fix the metal fitting on the furniture elements with the use of provided components. The assembly method of individual metal fitting is described in instruction manual „**Assembly of Accessories**”

Make sure that there are no shaving residues in the holes. Clear the holes if necessary.

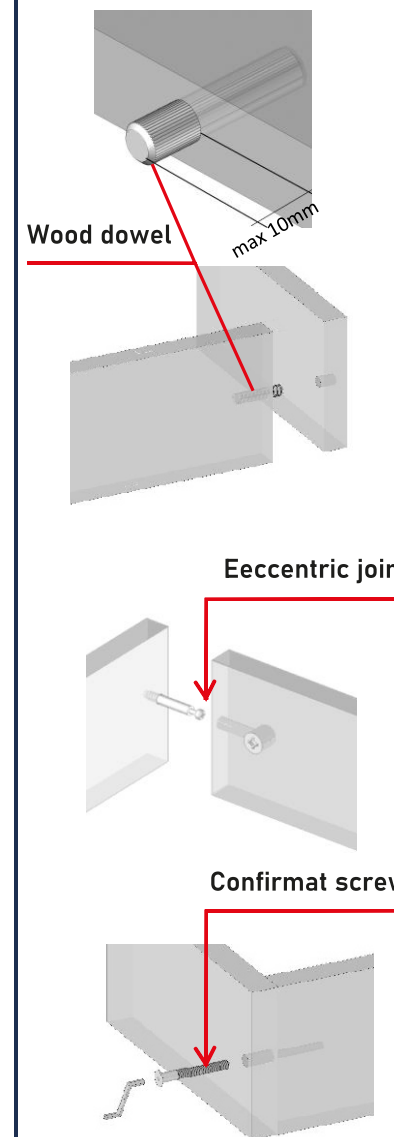
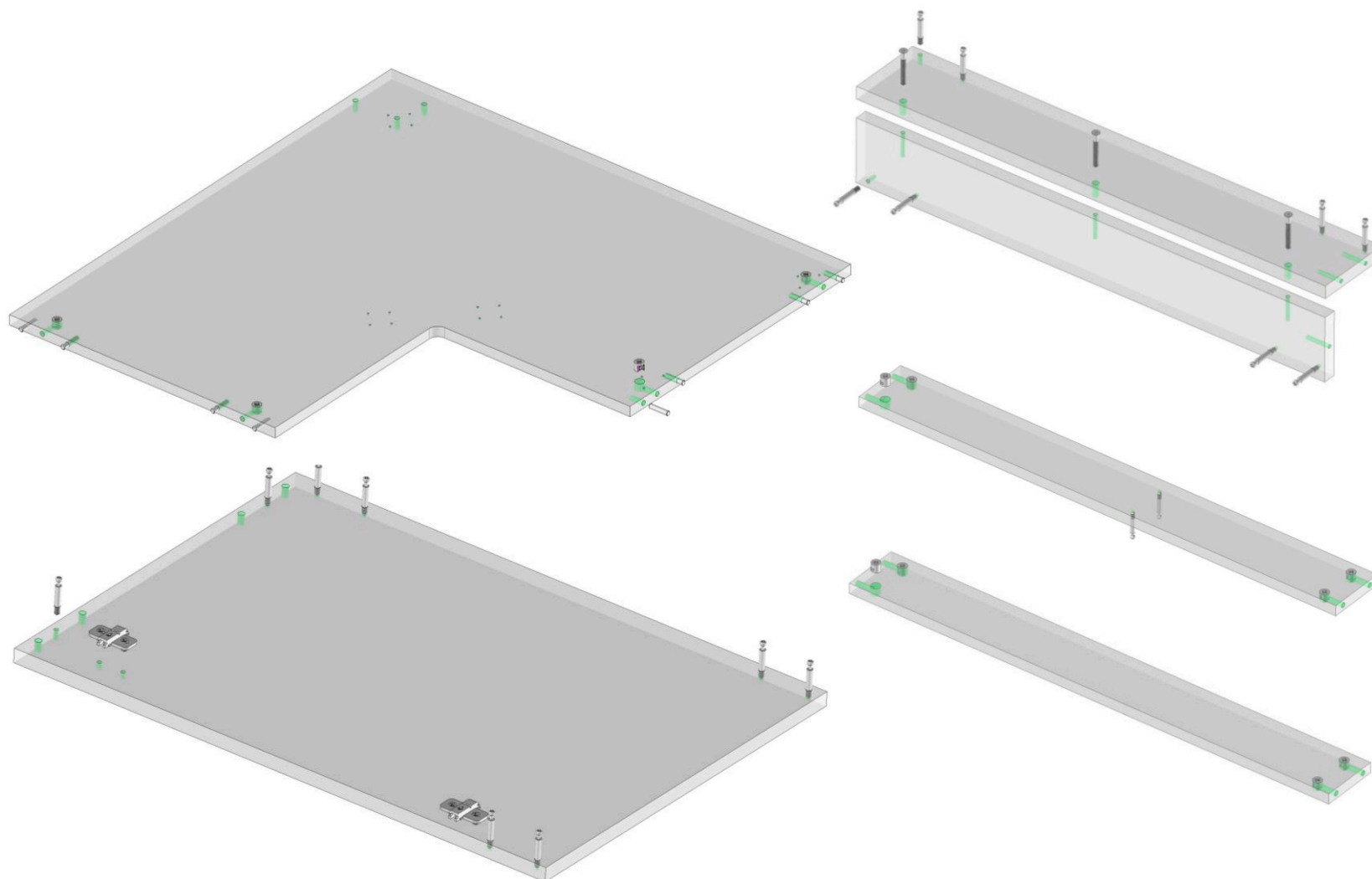



Join individual furniture elements together (the figure shows the version of the cabinet carcass with a sink on the right side – strip layout for the version with left-sided sink as per page 2).

The recommended order of cabinet carcass assembly:

1. Screw together strips 6 and 7 with the use of confirmats.
2. Fix the assembled angle 6-7 to the cabinet bottom panel 3.
3. Fix strips 12 and 13 together
4. Fix strips 8, 9, 10, and 11 with angle 6-7.
5. Fix the joined strips 12-13 with:
 - Strip 8 – for version with a right-sided sink
 - Strip 10 – for version with a left-sided sink
6. Fix left side 1 to cabinet bottom panel 3 and strips 12 and 8.
7. Fix right side 2 to cabinet bottom panel 3 and strips 13 and 10.

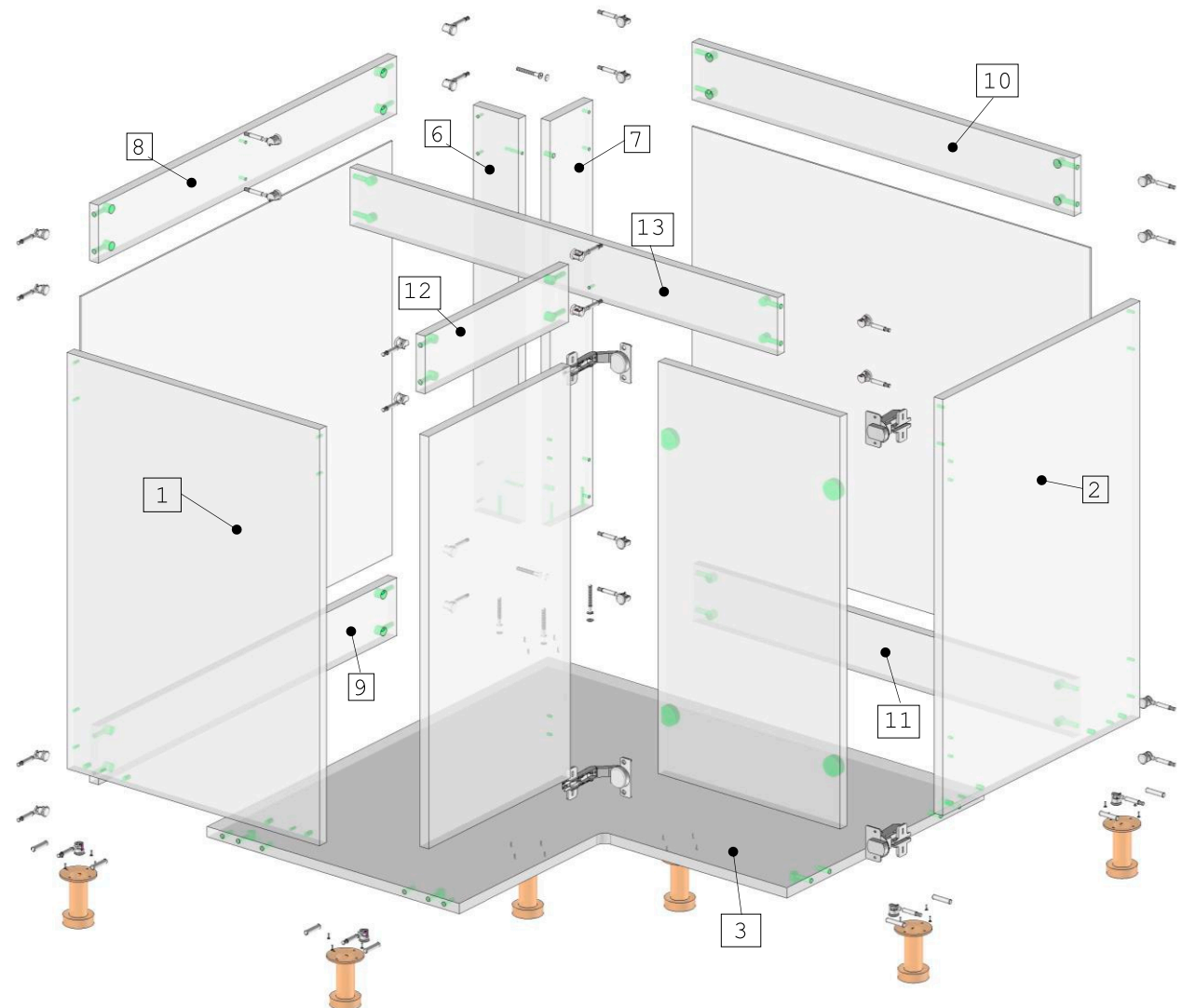
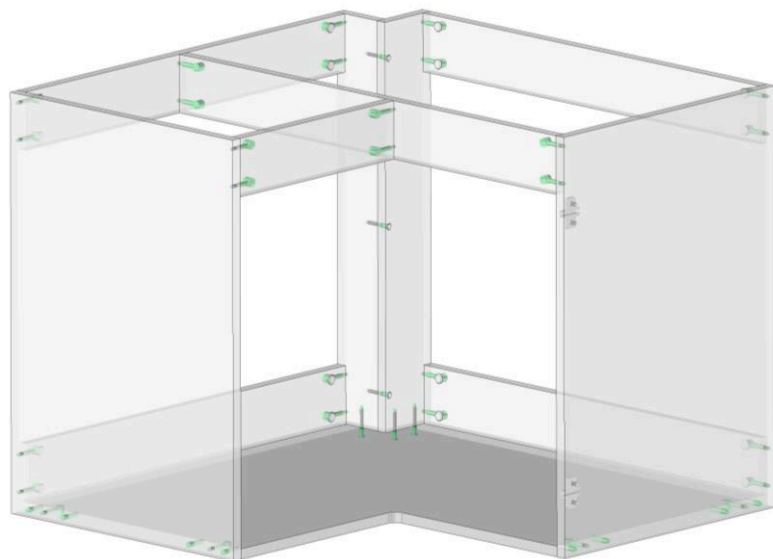



Set the rectangularity of the cabinet and assemble the back wall with the use of the nails provided (there are two back walls in the cabinet set – it is required to cut out an inspection hole on the side of the water supply and sewage connection, or to refrain from assembling the back wall on that side).

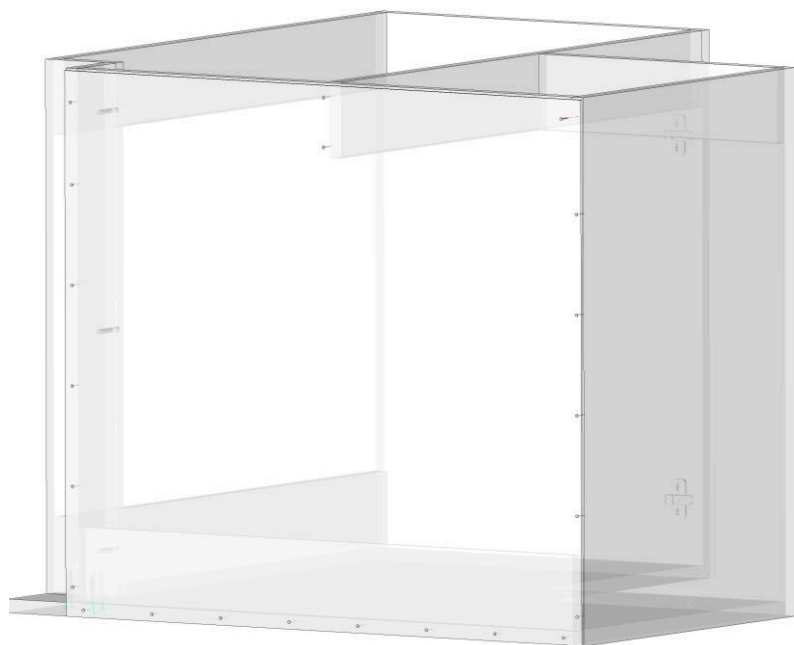

Attach the legs to the cabinet bottom panel using the provided bolts.

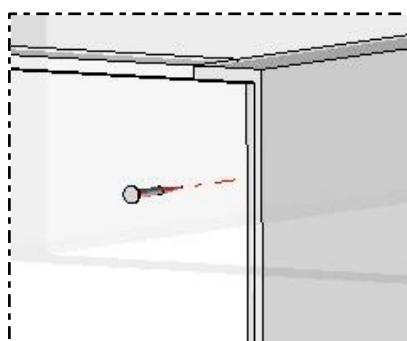
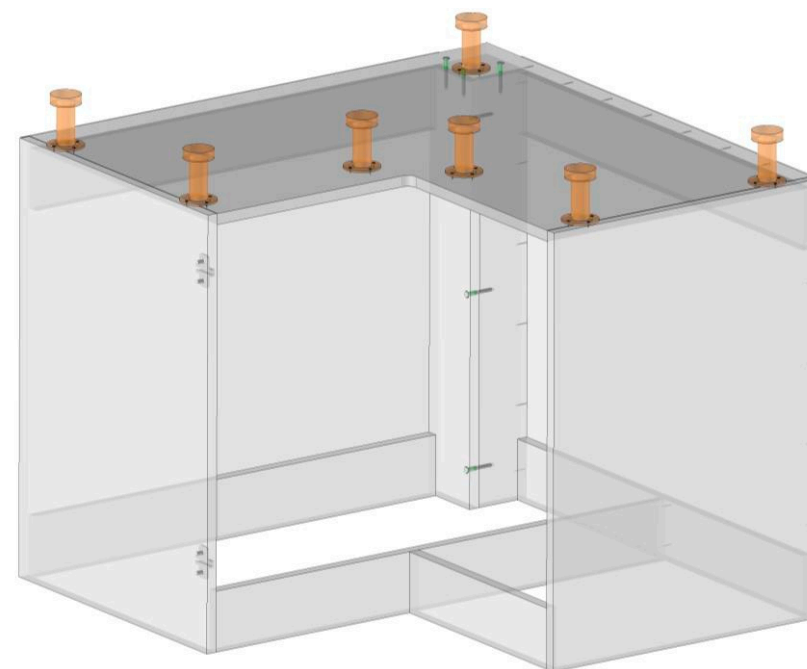



Screw together the hinges, and the guides to the door.

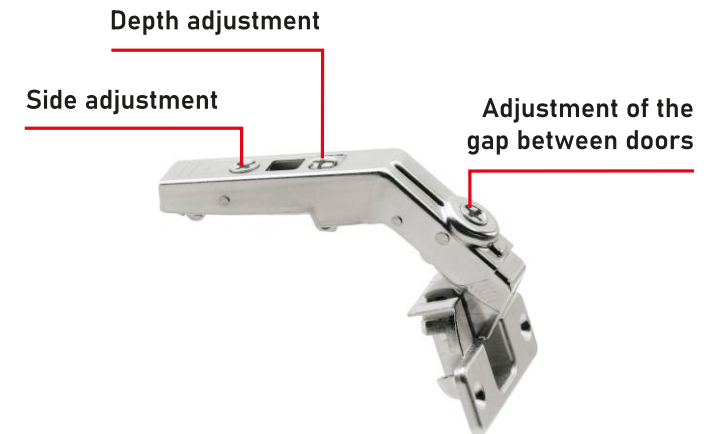
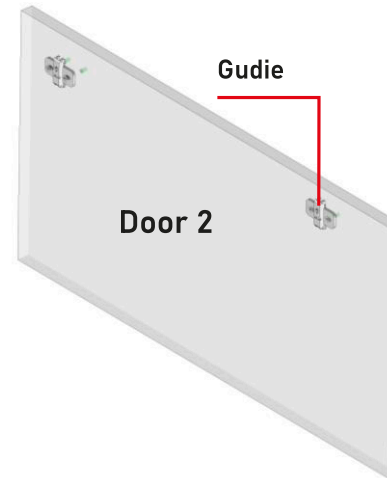
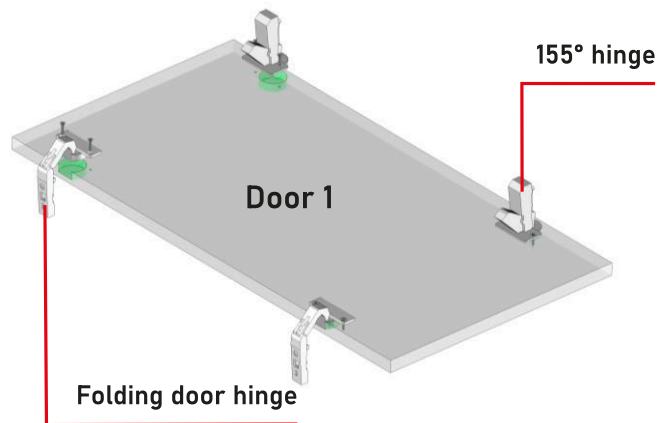

Fix together the two doors with metal fittings, and assemble it on the cabinet carcass. Adjust the position of doors (the adjustment of the depth, side and the gap between the doors can be performed on the hinges).

The vertical position of the doors can be adjusted on the guide (by loosening screws, setting the desired position of the doors, and tightening the screws again)

